

Quick Change Adaptor Style : Tension and Compression Tapping

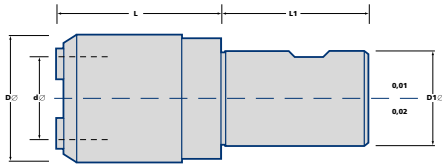

| Ordering No. | Stock | Tap Range | Ten. | Comp. | DØ | D1Ø | dØ | L | L1 |
|---------------|-------|-----------|------|-------|------|-----|----|----|----|
| SS200-TB0-077 | ○ | M1-M8 | 5.0 | 6.5 | 25.5 | 20 | 13 | 37 | 40 |
| SS200-TB1-076 | ● | M4-M14 | 7.5 | 7.5 | 36.0 | 20 | 19 | 36 | 40 |
| SS250-TB1-076 | ● | M4-M14 | 7.5 | 7.5 | 36.0 | 25 | 19 | 36 | 40 |
| SS250-TB2-105 | ● | M7-M24 | 12.5 | 12.5 | 53.0 | 25 | 31 | 65 | 40 |

Quick Change Adaptor Style – For Collet Chuck or Side Lock Adaptors

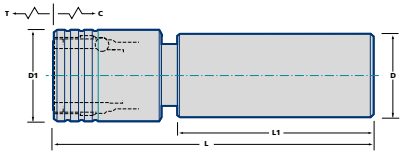

| Ordering No. | Stock | Collets | Range | D | D1 | L | L1 | T | C |
|---------------|-------|---------|--------|----|----|-----|-----|----|---|
| SS200-TB0-185 | ● | M1-M8 | RC/RS0 | 20 | 25 | 185 | 155 | 8 | 3 |
| SS250-TB1-113 | ○ | M4-M14 | RC/RS1 | 25 | 39 | 113 | 65 | 15 | 5 |
| SS320-TB1-118 | ● | M4-M14 | RC/RS1 | 32 | 39 | 118 | 70 | 15 | 5 |
| SS400-TB1-133 | ○ | M4-M14 | RC/RS1 | 40 | 39 | 133 | 82 | 15 | 5 |
| SS450-TB1-133 | ○ | M4-M14 | RC/RS1 | 45 | 39 | 133 | 82 | 15 | 5 |
| SS450-TB2-154 | ○ | M7-M24 | RC/RS2 | 45 | 52 | 154 | 82 | 15 | 5 |
| SS450-TB3-184 | ○ | M14-M42 | RC/RS3 | 45 | 75 | 184 | 82 | 15 | 5 |
| SS500-TB1-133 | ○ | M4-M14 | RC/RS1 | 50 | 39 | 133 | 82 | 15 | 5 |
| SS500-TB2-154 | ○ | M7-M24 | RC/RS2 | 50 | 52 | 154 | 82 | 15 | 5 |
| SS500-TB3-184 | ○ | M14-M42 | RC/RS3 | 50 | 75 | 184 | 82 | 15 | 5 |

Ancillaries

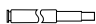
| Tap Adaptors | Tap Extensions |
|--|--|
|  See page 124-128 |  See page 132 |

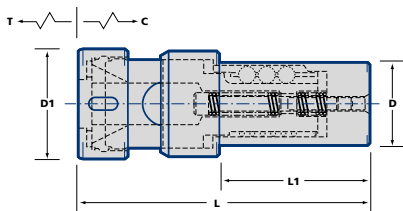

Tension & Compression Tapping Head



All the above Tapping heads are supplied complete with Collets and Drivers to hold the stated ranges of ISO Taps complete with Wrench.

| Ordering No. | Stock | Range (ISO) | D | D1 | L | L1 | T | C |
|---------------|-------|-------------|----|----|-----|----|----|---|
| SS400-T52-151 | ○ | M3-M16 | 40 | 48 | 151 | 82 | 15 | 5 |
| SS450-T52-151 | ○ | M3-M16 | 45 | 48 | 151 | 82 | 15 | 5 |
| SS450-T53-159 | ○ | M14-M33 | 45 | 63 | 159 | 82 | 15 | 5 |
| SS500-T52-151 | ○ | M3-M16 | 50 | 48 | 151 | 82 | 15 | 5 |
| SS500-T53-159 | ○ | M14-M33 | 50 | 63 | 159 | 82 | 15 | 5 |

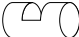
Ancillaries

| Wrenches | Driver | Rubberflex | Locknuts |
|--|--|--|--|
|  See page 131 |  See page 141-142 |  See page 122 |  See page 141 |

● = Standard Product - Normally Ex Stock
○ = Standard Product - Availability on Request

Packing unit and ordering example: 1 piece SS200-TB0-077