

■ Morse Taper Sleeves

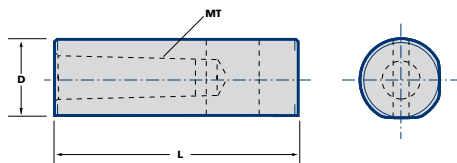

Ordering No.	Stock	D	MT	L
SS250- MT1- 075	•	25	1	75
SS250- MT1- 100	•	25	1	100
SS250- MT2- 075	•	25	2	75
SS250- MT2- 100	•	25	2	100
SS320- MT1- 100	○	32	1	100
SS320- MT2- 100	•	32	2	100
SS320- MT3- 100	•	32	3	100
SS400- MT1- 100	•	40	1	100
SS400- MT2- 100	•	40	2	100
SS400- MT3- 100	•	40	3	100
SS400- MT4- 120	•	40	4	120
SS450- MT1- 100	○	45	1	100
SS450- MT2- 100	○	45	2	100
SS450- MT3- 100	○	45	3	100
SS450- MT4- 100	○	45	4	100
SS500- MT2- 100	•	50	2	100
SS500- MT3- 100	○	50	3	100
SS500- MT4- 120	○	50	4	120
SS500- MT5- 175	•	50	5	175

• = Standard Product - Normally Ex Stock
○ = Standard Product - Availability on Request

Packing unit and ordering example: 1 piece SS250-MT1-075