

## SuperaC: Special Hydraulic

### Workholding Applications

#### ■ Expanders For Workholding Applications

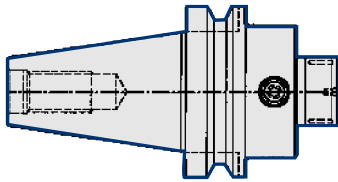
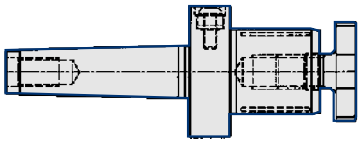

- For gripping on internal diameters
- Can be used as inspection fixture
- Accurate location - within 3 microns
- Taper/flange mounted
- Gripping diameter up to 60mm
- 3 micron run out

#### ■ Hydraulic Gripping For Workholding Applications

Manual version

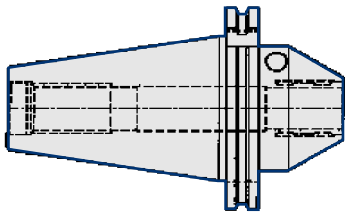

Automated version

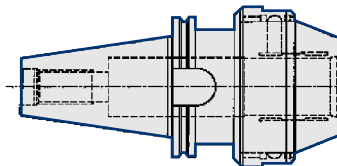

- Taper/flange mounted
- Manual screw generation
- Unique design, enables clamp/unclamp by robot in fully automated machining cycles
- Bore sizes up to 120mm

#### ■ Automated For Workholding Applications

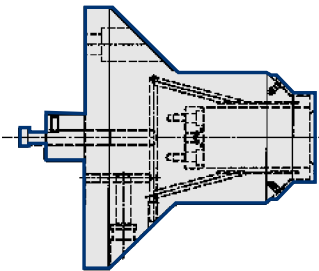
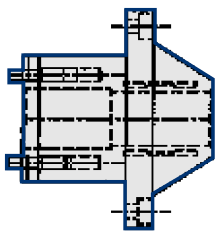

- Automatic clamping within machine cycle
- Used extensively on tool & cutter grinding machines as OEM fixture or retrofit
- High accuracy - 3 microns max run out
- Good access for grinding wheels/cutters

