

Single Angle TG Collet Chucks

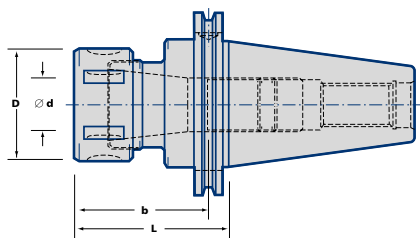

'B' form available
order example - CV40B-TG100-085

Taper	Ordering No.	Stock	Collets	Capacity d	L	b	D
40	CV40-TG100-085	○	100TG	6-25,5	85	72-100	60
	CV40-TG100-100	●	100TG	6-25,5	100	72-130	60
	CV40-TG100-150	○	150TG	12-40	150	84-107	85
50	CV50-TG100-085	○	100TG	6-25,5	85	72-125	60
	CV50-TG100-150	●	100TG	6-25,5	150	72-190	60
	CV50-TG150-085	○	150TG	12-40	85	84-103	85
	CV50-TG150-150	○	150TG	12-40	150	84-170	85

Spare Parts

Wrenches	Locknuts	Collets	Screws
See page 130	See page 138	See page 120	See page 138

Double Angle Collet Chucks

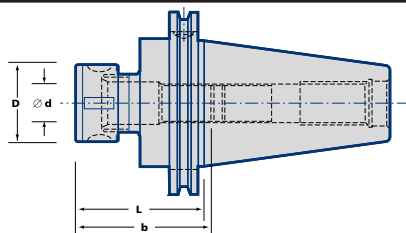

'B' form available
order example - CV40B-DA188-070

Taper	Ordering No.	Stock	Collets	Capacity d	L	b	D
40	CV40-DA208-070	●	200DA	1-10	70	38-75	28
	CV40-DA188-070	●	180DA	3-20	70	50-90	43
	CV40-DA188-100	●	180DA	3-20	100	50-115	43
50	CV50-DA188-070	●	180DA	3-20	70	50-90	43
	CV50-DA188-100	●	180DA	3-20	100	50-100	43
	CV50-DA188-150	●	180DA	3-20	150	50-170	43

Balanced by Design

Spare Parts

Wrenches	Locknuts	Collets	Screws
See page 130	See page 138	See page 120	See page 138

CV range available with imperial tapping sizes. Please call for availability.

● = Standard Product - Normally Ex Stock
○ = Standard Product - Availability on Request

Packing unit and ordering example: 1 piece CV40-TG100-085