

## End Mill/Sidelock Holders

Fig 1

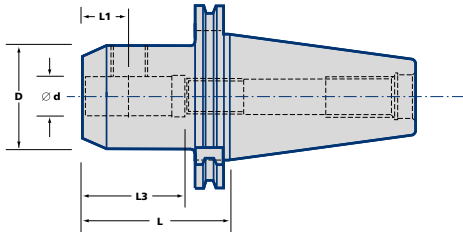

Fig 2

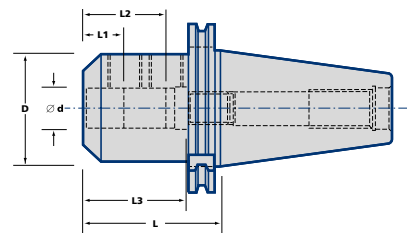
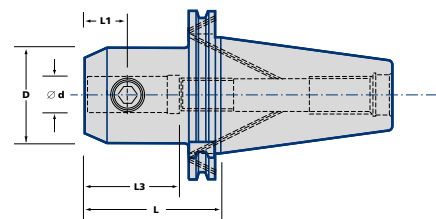

Fig 3



'B' Form Available  
 Order Example: DV40B-EM20-063  
 Also available with DV45 Taper, please call for details.

Taper	Ordering No.	Stock	fig	d	D	L	L1	L2	L3
30	DV30-EM06-050	•	1	6	25	50	18	-	40
	DV30-EM08-050	○	1	8	28	50	18	-	40
	DV30-EM10-050	•	1	10	35	50	20	-	45
	DV30-EM12-050	○	1	12	42	50	22,5	-	50
	DV30-EM16-063	○	1	16	48	63	24	-	53
	DV30-EM20-070	•	1	20	52	70	25	-	55
40	DV40-EM06-050	•	1	06	25	50	18	-	40
	DV40-EM08-050	•	1	08	28	50	18	-	40
	DV40-EM10-050	•	1	10	35	50	20	-	45
	DV40-EM12-050	•	1	12	42	50	22,5	-	50
	DV40-EM14-050	○	1	14	44	50	22,5	-	50
	DV40-EM16-063	•	1	16	48	63	24	-	53
	DV40-EM18-063	○	1	18	50	63	24	-	53
	DV40-EM20-063	•	1	20	52	63	25	-	55
	DV40-EM25-100	•	2	25	65	100	24	49	60
	DV40-EM32-100	•	2	32	72	100	24	52	64
DV40-EM40-120	•	2	40	80	120	30	62	74	

**Balanced by Design**

### Spare Parts

Sidelock Screws

Stopscrew



See page 139



See page 139

• = Standard Product - Normally Ex Stock  
 ○ = Standard Product - Availability on Request

Packing unit and ordering example: 1 piece DV30-EM06-050

End Mill/Sidelock Holders cont'd

Fig 1

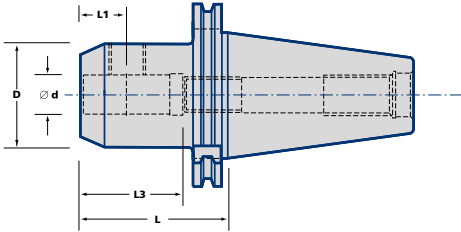

Fig 2

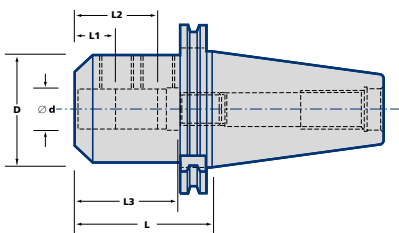
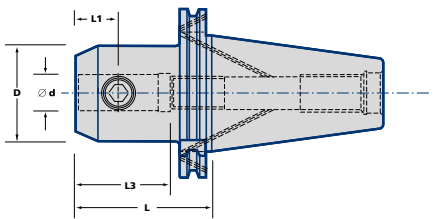

Fig 3



'B' Form Available  
Order Example:  
DV50B-EM20-063

**Balanced by Design**

Taper	Ordering No.	Stock	fig	d	D	L	L1	L2	L3
50	DV50-EM06-063	•	1	06	25	63	18	-	40
	DV50-EM06-150	•	1	06	25	150	18	-	40
	DV50-EM08-063	•	1	08	28	63	18	-	40
	DV50-EM08-150	•	1	08	28	150	18	-	40
	DV50-EM10-063	•	1	10	35	63	20	-	45
	DV50-EM10-150	•	1	10	35	150	20	-	45
	DV50-EM12-063	•	1	12	42	63	22,5	-	50
	DV50-EM12-150	•	1	12	42	150	22,5	-	50
	DV50-EM14-063	○	1	14	44	63	22,5	-	50
	DV50-EM14-150	○	1	14	44	150	22,5	-	50
	DV50-EM16-063	•	1	16	48	63	24	-	53
	DV50-EM16-150	•	1	16	48	150	24	-	53
	DV50-EM18-063	○	1	18	50	063	24	-	53
	DV50-EM18-150	○	1	18	50	150	24	-	53
	DV50-EM20-063	•	1	20	52	63	25	-	55
	DV50-EM20-150	•	1	20	52	150	25	-	55
	DV50-EM25-080	•	2	25	65	80	24	49	60
	DV50-EM32-100	•	2	32	72	100	24	52	64
	DV50-EM40-110	•	2	40	90	110	30	62	74
	DV50-EM50-120	•	2	50	100	120	35	70	84

Spare Parts

Sidelock Screws

Stopscrew



See page 139



See page 139

• = Standard Product - Normally Ex Stock  
○ = Standard Product - Availability on Request

Packing unit and ordering example: 1 piece DV50-EM06-065

## Short End Mill/Sidelock Adaptors

	Taper	Ordering No.	Stock	d	L	
	<b>40</b>		DV40-EM06-030	○	6	30
		DV40-EM08-030	○	8	30	
		DV40-EM10-032	○	10	32	
		DV40-EM12-034	○	12	34	
		DV40-EM16-035	○	16	35	
		DV40-TM16-035	○	16	35	
		DV40-EM20-035	○	20	35	
		DV40-TM20-035	●	20	35	
		DV40-TM25-035	○	25	35	
		DV40-EM25-045	●	25	45	
		DV40-EM25-060	○	25	60	
		DV40-EM32-070	●	32	70	
<b>50</b>		DV50-EM20-035	○	20	35	
		DV50-TM20-035	○	25	35	
		DV50-EM25-060	○	25	60	
		DV50-EM32-070	○	32	70	

## Spare Parts

Sidelock Screws	Stopscrew		
See page 139	See page 139		

● = Standard Product - Normally Ex Stock  
○ = Standard Product - Availability on Request

Packing unit and ordering example: 1 piece DV40-EM06-035