

ISO Taper Adaptors

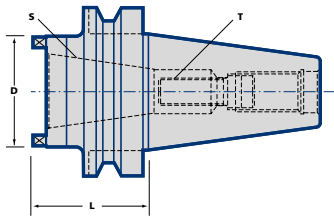

Taper	Ordering No.	Stock	ISO Taper ^S	L	D	T
40	BT40-TA30-040	○	30	40	48	M12
50	BT50-TA40-060	●	40	60	66	M16

Balanced by Design

Spare Parts

Retaining Screws



See page
141

Test/Setting Bars

Fig 1

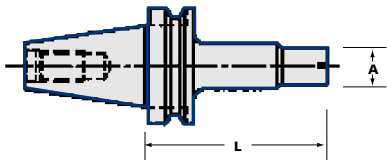
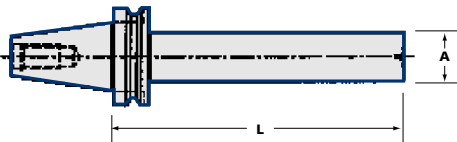

Fig 2



Taper	Ordering No.	Stock	fig	L	D
40	BT40-TB-020-100	○	1	100	20
	BT40-TB-030-200	○	2	200	30
50	BT50-TB-020-120	○	1	120	20
	BT50-TB-050-300	○	2	300	50

Fig 2 Test Bars supplied with a wooden box and calibration certificate

Greenstock Bar Blanks

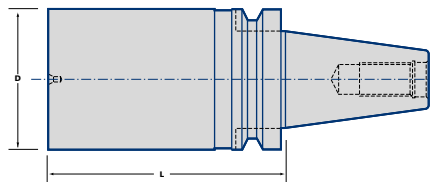

Taper	Ordering No.	Stock	L	D
30	BT30 BB-046-150	●	150	46
40	BT40- BB-063-157	●	157	63
	BT40- BB-063-280	●	280	63
	BT40- BB-082-280	●	280	82
	BT40- BB-104-200	●	200	104
50	BT50- BB-100-168	●	168	100
	BT50- BB-100-260	●	260	100
	BT50- BB-104-350	●	350	104
	BT50- BB-134-250	●	250	134

All Blanks have hardened and ground shanks with a machinable plain portion.

● = Standard Product - Normally Ex Stock
○ = Standard Product - Availability on Request

Packing unit and ordering example: 1 piece BT50-TA40-060