

## ■ Spare Tap Drivers: TS3

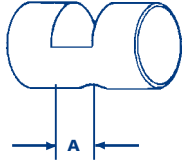

Ordering number for driver sets.  
For ISO set of drivers  
SET-TS3-ISO

For DIN set of drivers  
SET-TS3-DIN

ISO Standard				DIN Standard	
Ordering No.	Stock	No.	A	Ordering No.	A
STS-03DV01A	•	1	9.0	STS-03DDV09.0	9.0
STS-03DV02A	•	2	10.0	STS-03DDV11.0	11.0
STS-03DV03A	•	3	11.23	STS-03DDV12.0	12.0
STS-03DV04A	•	4	12.5	STS-03DDV14.5	14.5
STS-03DV05A	•	5	14.0	STS-03DDV16.0	16.0
STS-03DV06A	•	6	16.0	STS-03DDV18.0	18.0
STS-03DV07A	•	7	18.0		

## ■ Spares for Rigibore Units

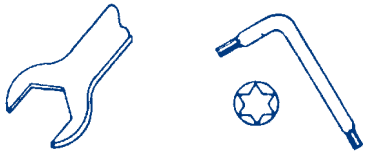

Stock	Unit Size	Dial Adjusting Spanner	Insert Wrench	Insert Screw
•	RGB - R2B2	RGB - R26	RGB - R27	RGB - DIT6
•	RGB - R3B1	RGB - R36	RGB - R27	RGB - DIT6
•	RGB - R3A2	RGB - R36	RGB - R37	RGB - 2005
•	RGB - R5B2	RGB - R36	RGB - R37	RGB - 2003
•	RGB - R5A2	RGB - R36	RGB - R37	RGB - 2003

## ■ Spares for Hydraulic Chucks

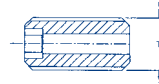

Bore Size	Slimline Pressure Screw	Heavy Duty Pressure Screw	Stop Screw Slimline & Heavy Duty
6	SHYDC-0717 (3 HEX)	HYDC-0818 (5 HEX)	CSS0510 (2,5 HEX)
8	SHYDC-0717 (3 HEX)	HYDC-0818 (5 HEX)	CSS0510 (2,5 HEX)
10	SHYDC-0717 (3 HEX)	HYDC-0818 (5 HEX)	CSS0612 (3 HEX)
12	SHYDC-0717 (3 HEX)	HYDC-0818 (5 HEX)	CSS0612 (3 HEX)
14	SHYDC-0717 (3 HEX)	HYDC-0818 (5 HEX)	CSS0815 (4 HEX)
16	SHYDC-0717 (3 HEX)	HYDC-0818 (5 HEX)	CSS0815 (4 HEX)
18	SHYDC-0717 (3 HEX)	HYDC-1018 (5 HEX)	CSS0815 (4 HEX)
20	SHYDC-0717 (3 HEX)	HYDC-1018 (5 HEX)	CSS0815 (4 HEX)
25	SHYDC-0720 (3 HEX)	HYDC-1023 (5 HEX)	CSS1015 (5 HEX)
32	SHYDC-1020 (5 HEX)	HYDC-1023 (5 HEX)	CSS1015 (5 HEX)
40	SHYDC-1020 (5 HEX)	HYDC-1023 (5 HEX)	CSS1015 (5 HEX)

• = Standard Product - Normally Ex Stock  
◦ = Standard Product - Availability on Request

Packing unit and ordering example: 1 piece STS-03DV01A