

## Accessories

### Assembly Fixture

For vertical and horizontal application

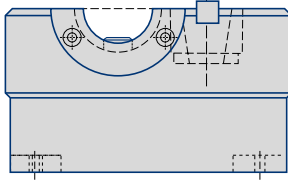

Bench Mounted

Ordering No.	Stock	
VHTF-DC40	○	
VHTF-DC50	○	
VHTF-DO40	○	
VHTF-DT50	○	
VHTF-BT40	●	
VHTF-BT50	●	

### Tightening Pots

Used for tightening toolholders out of the machine spindle.

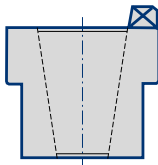

Vice Mounted

Ordering No.	Stock	Taper	L	D	
TF-30	●	30	57	70	
TF-35	○	35	60	70	
TF-40	●	40	65	75	
TF-45	○	45	82	85	
TF-50	●	50	100	100	

For HSK Tightening Pots see page 67

### Keyless Drill Chucks

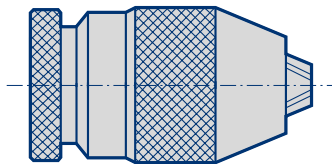

Ordering No.	Stock	Capacity	Mounting	DØ	L
KDC-010-J2	○	0-10	JT2	43	91
KDC-010-J33	●	0-10	JT33	43	91
KDC-113-J33	●	1-13	JT33	50	103
KDC-113-J6	●	1-13	JT6	50	103
KDC-316-B16	○	1-13	DTB16	50	103
KDC-316-J6	●	3-16	JT6	56	109
KDC-316-B16	○	3-16	DTB16	56	109

### Socket Wipers

Used for cleaning machine tool tapers.

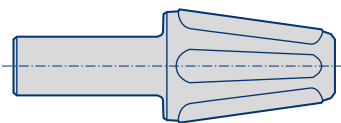

Ordering No.	Stock	Taper	
SW-30	●	30	
SW-40	●	40	
SW-45	○	45	
SW-50	●	50	

For HSK Socket Wipers see page 134

● = Standard Product - Normally Ex Stock  
○ = Standard Product - Availability on Request

Packing unit and ordering example: 1 piece VHTF-DC40