

Face Mill/Shell Mill Adaptors cont'd

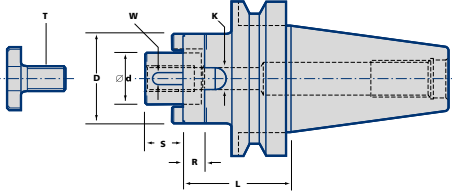

Note: When mounting Milling Cutters with bores $\varnothing 16$ and 22 , a Caphead screw is required - see page 140 Fig 1.

Taper	Ordering No.	Stock	d	W	K	D	L	S	R	T
30	BT30-CS16-045	○	16	4	8	32	45	17	10	M8
	BT30-CS22-047	○	22	6	10	40	47	19	12	M10
	BT30-CS27-049	○	27	7	12	48	49	21	12	M12
40	BT40-CS16-055	●	16	4	8	32	55	17	10	M8
	BT40-CS16-100	●	16	4	8	32	100	17	10	M8
	BT40-CS22-055	●	22	6	10	40	55	19	12	M10
	BT40-CS22-150	●	22	6	10	40	150	19	12	M10
	BT40-CS27-055	●	27	7	12	48	55	21	12	M12
	BT40-CS27-150	●	27	7	12	48	150	21	12	M12
	BT40-CS32-060	●	32	8	14	58	60	24	14	M16
	BT40-CS32-150	○	32	8	14	58	150	24	14	M16
	BT40-CS40-080	●	40	10	16	70	80	27	14	M20
50	BT50-CS16-070	○	16	4	8	32	70	17	10	M8
	BT50-CS16-150	○	16	4	8	32	150	17	10	M8
	BT50-CS22-070	○	22	6	10	40	70	19	12	M10
	BT50-CS22-150	○	22	6	10	40	150	19	12	M10
	BT50-CS22-200	○	22	6	10	40	200	19	12	M10
	BT50-CS27-070	○	27	7	12	48	70	21	12	M12
	BT50-CS27-150	○	27	7	12	48	150	21	12	M12
	BT50-CS32-070	○	32	8	14	58	70	24	14	M16
	BT50-CS32-150	●	32	8	14	58	150	24	14	M16
	BT50-CS40-070	○	40	10	16	70	70	27	14	M20
	BT50-CS40-150	○	40	10	16	70	150	27	14	M20
	BT50-CS40-200	○	40	10	16	70	200	27	14	M20

Balanced by Design

Spare Parts

Wrenches



See page 131

Drive Keys



See page 140

Drive Rings



See page 140

Retaining Screws



See page 140

● = Standard Product - Normally Ex Stock
○ = Standard Product - Availability on Request

Packing unit and ordering example: 1 piece BT40-CS16-055