

■ **Morse Taper Adaptors (Tang Type)**

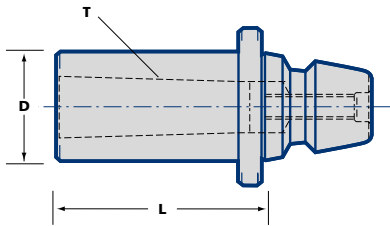

Ordering No.	Stock	MT	L	D
EC-MT1-051	•	1	051	25
EC-MT2-062	•	2	062	32
EC-MT3-117	•	3	117	40

■ **Jacobs/DIN 238 Adaptors**

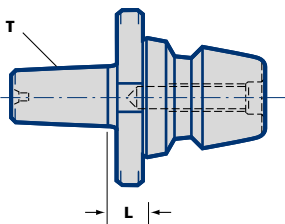

Ordering No.	Stock	JT	L
EC-JT2-010	•	2	10
EC-JT3-011	•	3	11
EC-JT33-010	•	33	10
EC-JT6-010	•	6	10

■ **Greenstock Bar Blanks**

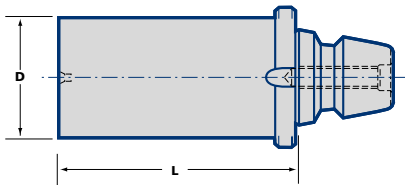

Ordering No.	Stock	D	L
EC-BB-040-080	•	40	80
EC-BB-040-120	•	40	120

All blanks have hardened and ground shanks with a machinable plain portion

■ **Tightening Fixture**

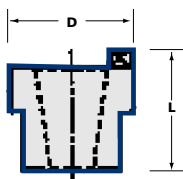

Ordering No.	Stock	D	L
TF-EC	•	58	58

■ **Boring Head Adaptor**

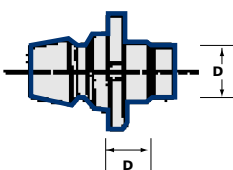

Ordering No.	Stock	D	L
EC-CBI0875-015	•	7/8" x 20	15

• = Standard Product - Normally Ex Stock
 ○ = Standard Product - Availability on Request

Packing unit and ordering example: 1 piece EC-MT1-051