

End Mill/Sidelock Adaptors

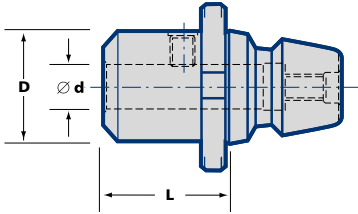

| Ordering No. | Stock | d | D | L |
|----------------|-------|-------|----|----|
| EC-EM06-035 | • | 6 | 30 | 35 |
| EC-EM10-035 | • | 10 | 30 | 35 |
| EC-EM12-035 | • | 12 | 30 | 35 |
| EC-EM16-035 | • | 16 | 30 | 35 |
| EC-EM20-055 | ○ | 20 | 45 | 55 |
| EC-EM25-075 | ○ | 25 | 55 | 75 |
| EC-EMI0187-035 | • | 3/16" | 19 | 35 |
| EC-EMI0250-035 | • | 1/4" | 19 | 35 |
| EC-EMI0375-035 | • | 3/8" | 26 | 35 |
| EC-EMI0500-035 | • | 1/2" | 32 | 35 |
| EC-EMI0625-040 | • | 5/8" | 41 | 35 |
| EC-EMI0750-055 | • | 3/4" | 46 | 35 |
| EC-EMI1000-075 | • | 1" | 51 | 75 |

Face Mill/Shell Mill Adaptors

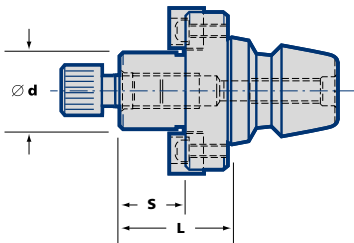

| Ordering No. | Stock | d | D | L | S |
|----------------|-------|------|----|----|----|
| EC-SM16-014 | ○ | 16 | 44 | 14 | 17 |
| EC-SM22-014 | • | 22 | 50 | 14 | 19 |
| EC-SMI0500-014 | • | 1/2" | 32 | 14 | 15 |
| EC-SMI0750-014 | • | 3/4" | 44 | 14 | 18 |

Spare parts

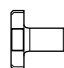
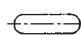
| Wrenches | Retaining Screws | Drive Keys |
|--|--|--|
|  See page 131 |  See page 140 |  See page 140 |

EasyChange Tray



| Ordering No. | Stock |
|--------------|-------|
| TS-ECTRAY | • |

• = Standard Product - Normally Ex Stock
 ○ = Standard Product - Availability on Request

Packing unit and ordering example: 1 piece EC-EM06-035