

EasyChange Basic Holder

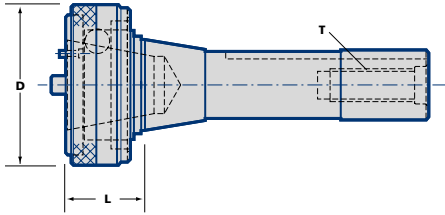

Ordering No.	Stock	Back End	L	D	T
R8-EC-027	•	R8	27	60	7/16" UNF
QC30-EC-060	•	ISO30	60	60	M12
QC40-EC-049	•	ISO40	50	60	M16
QC40I-EC-050	○	ISO40	50	60	5/8" UNC
MT3-EC-051	○	3 MORSE	51	60	TANG
SS320-EC-027	○	32mm S/S	27	60	-
SS1250-EC-027	○	1 1/4" S/S	27	60	-

ER Single Angle Collet Chucks

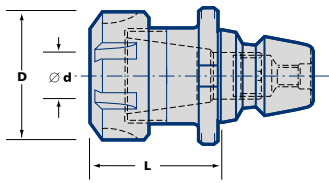

Ordering No.	Stock	Capacity d	L	D
EC-ER16-040	•	1-10	40	28
EC-ER20-040	•	1-13	40	34
EC-ER25-045	•	1-16	45	42
EC-ER32-050	•	2-20	50	50

Ancillaries

Wrenches	Locknuts	Collets	Screws
See page 130	See page 138	See page 121	See page 138

DA Double Angle Collet Chucks

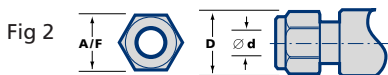
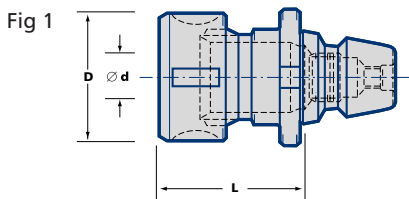

Ordering No.	Stock	Style	Capacity d	L	D	A/F
EC-DA 208-041	•	2	1-10	41	27	24
EC-DA188-049	•	1	3-20	49	43	-

Ancillaries

Wrenches	Locknuts	Collets	Screws
See page 130	See page 138	See page 121	See page 138

• = Standard Product - Normally Ex Stock
 ○ = Standard Product - Availability on Request

Packing unit and ordering example: 1 piece R8-EC-027