

## HEAT SHRINK TOOLHOLDERS

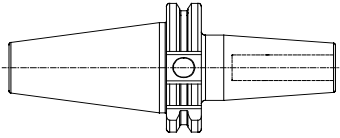

Taper	Ordering No.	Stock	d	L	D1	D2	L3
40	CV40-TT60-095G63	●	6	95	20	27	36
	CV40-TT80-095G63	●	8	95	20	27	36
	CV40-TT10-095G63	●	10	95	24	32	42
	CV40-TT12-095G63	●	12	95	24	32	47
	CV40-TT14-095G63	●	14	95	27	34	47
	CV40-TT16-095G63	●	16	95	27	34	50
	CV40-TT18-095G63	●	18	95	33	42	50
	CV40-TT20-095G63	●	20	95	33	42	52
	CV40-TT25-110G63	●	25	110	44	53	58
40	CV40-TT06-120G63	○	6	120	20	27	36
	CV40-TT08-120G63	○	8	120	20	27	36
	CV40-TT10-120G63	○	10	120	24	32	42
	CV40-TT12-120G63	○	12	120	24	32	47
	CV40-TT14-120G63	○	14	120	27	34	47
	CV40-TT16-120G63	○	16	120	27	34	50
	CV40-TT18-120G63	○	18	120	33	42	50
	CV40-TT20-120G63	○	20	120	33	42	52
	CV40-TT25-120G63	○	25	120	44	53	58
40	CV40-TT06-160G63	○	6	160	20	32	36
	CV40-TT08-160G63	○	8	160	20	32	36
	CV40-TT10-160G63	○	10	160	24	34	42
	CV40-TT12-160G63	○	12	160	24	34	47
	CV40-TT14-160G63	○	14	160	27	42	47
	CV40-TT16-160G63	○	16	160	27	42	50
	CV40-TT18-160G63	○	18	160	33	44.4	50
	CV40-TT20-160G63	○	20	160	33	44.4	52
	CV40-TT25-160G63	○	25	160	44	53	58
50	CV50-TT06-95G63	●	6	95	20	27	36
	CV50-TT08-95G63	●	8	95	20	27	36
	CV50-TT10-95G63	●	10	95	24	32	42
	CV50-TT12-95G63	●	12	95	24	32	47
	CV50-TT14-95G63	●	14	95	27	34	47
	CV50-TT16-95G63	●	16	95	27	34	50
	CV50-TT18-95G63	●	18	95	33	42	50
	CV50-TT20-95G63	●	20	95	33	42	52
	CV50-TT25-105G63	○	25	105	44	58	58
CV50-TT32-105G63	○	32	105	44	58	58	
50	CV50-TT06-120G63	○	6	120	20	27	36
	CV50-TT08-120G63	○	8	120	20	27	36
	CV50-TT10-120G63	○	10	120	24	32	42
	CV50-TT12-120G63	○	12	120	24	32	47
	CV50-TT14-120G63	○	14	120	27	34	47
	CV50-TT16-120G63	○	16	120	27	34	50
	CV50-TT18-120G63	○	18	120	33	42	50
	CV50-TT20-120G63	○	20	120	33	42	52
	CV50-TT25-120G63	○	25	120	44	58	58
CV50-TT32-120G63	○	32	120	44	58	58	
50	CV50-TT06-160G63	○	6	160	20	32	36
	CV50-TT08-160G63	○	8	160	20	32	36
	CV50-TT10-160G63	○	10	160	24	34	42
	CV50-TT12-160G63	○	12	160	24	34	47
	CV50-TT14-160G63	○	14	160	27	42	47
	CV50-TT16-160G63	○	16	160	27	42	50
	CV50-TT18-160G63	○	18	160	33	50	50
	CV50-TT20-160G63	○	20	160	33	50	52
	CV50-TT25-160G63	○	25	160	44	58	58
CV50-TT32-160G63	○	32	160	44	58	58	

For Shank Tolerance h6  
Balanced G6.3@15,000 rpm  
Max run out at nose 0.003mm

● = Standard Product - Normally Ex-Stock  
○ = Standard Product - Availability on Request

Packing Unit and Ordering Example  
1 piece CV50-TT20-160G63