

SuperaC Slimline Toolholder : HSK - A + C DIN 69893

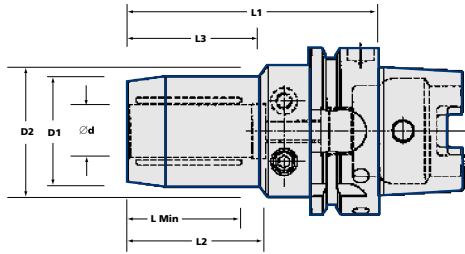

Please Note: Other HSK sizes and gauge lengths available on request.

HSK 'E' for high speed applications also available.

Please phone for details.

Dynamically balanced to G2.5 at 20,000 rpm
Order example
HSK50A – SHYD06-080G2.5

For Coolant Tube and Wrench see page 134

Taper	Ordering No.	Stock	d	D1	D2	L1	L2	L3	Lmin
50	HSK50A-SHYD06-080	○	6	26	42	80	38	24	23
	HSK50A-SHYD08-080	○	8	28	42	80	38	24	24
	HSK50A-SHYD10-085	○	10	30	42	85	40	26	30
	HSK50A-SHYD12-090	○	12	32	42	90	45	40	36
63	HSK63A-SHYD06-080	●	6	26	50	80	38	24	23
	HSK63A-SHYD08-080	○	8	28	50	80	38	24	24
	HSK63A-SHYD10-085	○	10	30	50	85	40	26	30
	HSK63A-SHYD12-090	●	12	32	50	90	45	40	36
	HSK63A-SHYD14-090	○	14	34	50	90	45	40	40
	HSK63A-SHYD16-095	●	16	38	50	95	50	46	40
	HSK63A-SHYD18-095	○	18	40	50	95	52	50	43
	HSK63A-SHYD20-100	●	20	42	50	100	52	50	43
	HSK63A-SHYD25-105	○	25	53	-	105	59	-	46
HSK63A-SHYD32-125	○	32	60	-	125	60	-	51	
80	HSK80A-SHYD06-085	○	6	26	50	85	38	24	23
	HSK80A-SHYD08-085	○	8	28	50	85	38	24	24
	HSK80A-SHYD10-090	○	10	30	50	90	40	26	30
	HSK80A-SHYD12-095	●	12	32	50	95	45	40	36
	HSK80A-SHYD14-095	○	14	34	50	95	45	40	40
	HSK80A-SHYD16-100	●	16	38	50	100	50	46	40
	HSK80A-SHYD18-100	○	18	40	50	100	52	50	43
	HSK80A-SHYD20-105	●	20	42	50	105	52	50	43
	HSK80A-SHYD25-115	○	25	53	-	115	59	-	46
	HSK80A-SHYD32-125	●	32	60	-	125	60	-	51
100	HSK100A-SHYD06-085	○	6	26	50	85	38	24	23
	HSK100A-SHYD08-085	○	8	28	50	85	38	24	24
	HSK100A-SHYD10-090	○	10	30	50	90	40	26	30
	HSK100A-SHYD12-095	●	12	32	50	95	45	40	36
	HSK100A-SHYD14-095	○	14	34	50	95	45	40	40
	HSK100A-SHYD16-100	●	16	38	50	100	50	46	40
	HSK100A-SHYD18-100	○	18	40	50	100	52	50	43
	HSK100A-SHYD20-105	●	20	42	50	105	52	50	43
	HSK100A-SHYD25-115	○	25	53	-	115	59	-	46
	HSK100A-SHYD32-120	●	32	60	-	120	60	-	51

Balanced by Design

Spare Parts

Pressure Screw

Stopscrew



See page 142



See page 142