

## SuperaC Slimline Toolholder : HSK - A + C DIN 69893

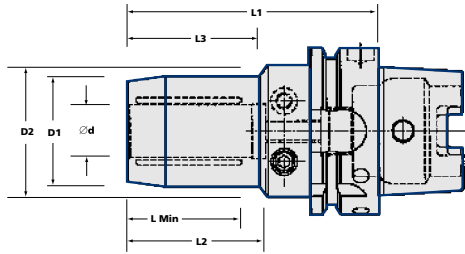

**Please Note:** Other HSK sizes and gauge lengths available on request.

HSK 'E' for high speed applications also available.

Please phone for details.

Dynamically balanced to G2.5 at 20,000 rpm  
Order example  
HSK50A – SHYD06-080G2.5

For Coolant Tube and Wrench see page 134

Taper	Ordering No.	Stock	d	D1	D2	L1	L2	L3	Lmin
<b>50</b>	HSK50A-SHYD06-080	○	6	26	42	80	38	24	23
	HSK50A-SHYD08-080	○	8	28	42	80	38	24	24
	HSK50A-SHYD10-085	○	10	30	42	85	40	26	30
	HSK50A-SHYD12-090	○	12	32	42	90	45	40	36
<b>63</b>	HSK63A-SHYD06-080	●	6	26	50	80	38	24	23
	HSK63A-SHYD08-080	○	8	28	50	80	38	24	24
	HSK63A-SHYD10-085	○	10	30	50	85	40	26	30
	HSK63A-SHYD12-090	●	12	32	50	90	45	40	36
	HSK63A-SHYD14-090	○	14	34	50	90	45	40	40
	HSK63A-SHYD16-095	●	16	38	50	95	50	46	40
	HSK63A-SHYD18-095	○	18	40	50	95	52	50	43
	HSK63A-SHYD20-100	●	20	42	50	100	52	50	43
	HSK63A-SHYD25-105	○	25	53	-	105	59	-	46
HSK63A-SHYD32-125	○	32	60	-	125	60	-	51	
<b>80</b>	HSK80A-SHYD06-085	○	6	26	50	85	38	24	23
	HSK80A-SHYD08-085	○	8	28	50	85	38	24	24
	HSK80A-SHYD10-090	○	10	30	50	90	40	26	30
	HSK80A-SHYD12-095	●	12	32	50	95	45	40	36
	HSK80A-SHYD14-095	○	14	34	50	95	45	40	40
	HSK80A-SHYD16-100	●	16	38	50	100	50	46	40
	HSK80A-SHYD18-100	○	18	40	50	100	52	50	43
	HSK80A-SHYD20-105	●	20	42	50	105	52	50	43
	HSK80A-SHYD25-115	○	25	53	-	115	59	-	46
	HSK80A-SHYD32-125	●	32	60	-	125	60	-	51
<b>100</b>	HSK100A-SHYD06-085	○	6	26	50	85	38	24	23
	HSK100A-SHYD08-085	○	8	28	50	85	38	24	24
	HSK100A-SHYD10-090	○	10	30	50	90	40	26	30
	HSK100A-SHYD12-095	●	12	32	50	95	45	40	36
	HSK100A-SHYD14-095	○	14	34	50	95	45	40	40
	HSK100A-SHYD16-100	●	16	38	50	100	50	46	40
	HSK100A-SHYD18-100	○	18	40	50	100	52	50	43
	HSK100A-SHYD20-105	●	20	42	50	105	52	50	43
	HSK100A-SHYD25-115	○	25	53	-	115	59	-	46
	HSK100A-SHYD32-120	●	32	60	-	120	60	-	51

**Balanced by Design**

### Spare Parts

Pressure Screw

Stopscrew



See page 142



See page 142

● = Standard Product. ○ = Available on request

Packing unit and ordering example: 1 piece HSK50A-SHYD06-080

# SuperaC Hydraulic Chuck

## SuperaC Chuck : DIN 2080-A

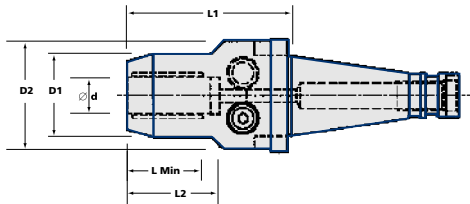

Taper	Ordering No.	Stock	d	D1	D2	L1	L2	Lmin
40	DT40-HYD06-082	○	6	36	56	82	34	23
	DT40-HYD08-082	○	8	36	56	82	34	24
	DT40-HYD10-082	○	10	36	56	82	38	30
	DT40-HYD12-082	●	12	36	56	82	42	35
	DT40-HYD16-082	○	16	40	56	82	45	40
	DT40-HYD20-082	●	20	46	60	92	52	43
	DT40-HYD25-082	○	25	55	65	96	56	46
50	DT50-HYD06-082	○	6	36	56	90	34	23
	DT50-HYD08-082	○	8	36	56	90	34	24
	DT50-HYD10-082	○	10	36	56	90	38	30
	DT50-HYD12-082	●	12	36	56	90	42	35
	DT50-HYD16-082	○	16	40	56	90	45	40
	DT50-HYD20-082	●	20	46	60	96	52	43
	DT50-HYD25-082	○	25	55	65	100	56	46
	DT50-HYD32-082	●	32	60	72	102	60	51

## Spare Parts

Pressure Screw



See page 142

Stopscrew



See page 142

## SuperaC Hydraulic Toolholder Accessories : Clamp Force Test Piece

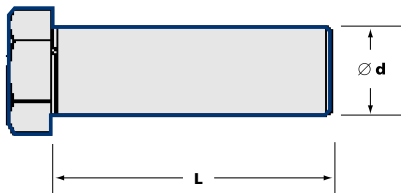

Ordering No.	Stock	A/F	d	L
CFTP-0600	●	13	6	40
CFTP-0800	●	13	8	40
CFTP-1000	●	13	10	45
CFTP-1200	●	13	12	50
CFTP-1400	●	13	14	50
CFTP-1600	●	19	16	50
CFTP-1800	●	19	18	55
CFTP-2000	●	19	20	60
CFTP-2500	●	32	25	60
CFTP-3200	●	32	32	65
CFTP-4000	●	32	40	68

● = Standard Product. ○ = Available on request

Packing unit and ordering example: 1 piece DT40-HYD06-082

## ■ SuperaC Reduction Sleeve (Sealed)

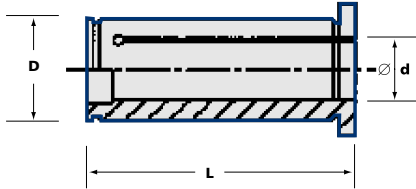

**Please Note:**

Imperial Bore Sizes also available,  
please phone for details.

Taper	Ordering No.	Stock	D	d	L
<b>12</b>	PC12-0300	•	12	3	42
	PC12-0400	•	12	4	42
	PC12-0500	•	12	5	42
	PC12-0600	•	12	6	42
	PC12-0800	•	12	8	42
	PC12-1000	•	12	10	42
<b>20</b>	PC20-0600	•	20	6	57
	PC20-0800	•	20	8	57
	PC20-1000	•	20	10	57
	PC20-1200	•	20	12	57
	PC20-1400	•	20	14	57
	PC20-1600	•	20	16	57
<b>32</b>	PC32-0600	•	32	6	65
	PC32-0800	•	32	8	65
	PC32-1000	•	32	10	65
	PC32-1200	•	32	12	65
	PC32-1400	•	32	14	65
	PC32-1600	•	32	16	65
	PC32-1800	•	32	18	65
	PC32-2000	•	32	20	65
PC32-2500	•	32	25	65	

## SuperaC: Special Hydraulic Rotating Toolholder Applications

### ■ Extended Gauge Lengths

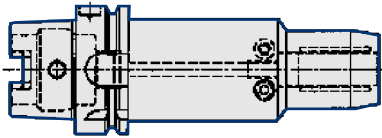

- Full range of extended hydraulics on all Tapers
- Extensions up to 300mm possible.
- TIR 3 microns at nose.

### ■ HSK - High Speed Applications Up To 40,000 rpm

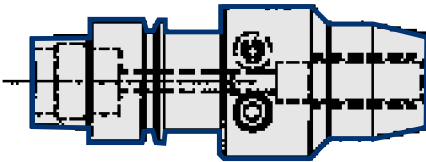

- Hydraulic front ends available on all high speed HSK Tapers A,E,F.
- Drawing depicts HSK 32E to HYD 12.

### ■ Rotary Coolant

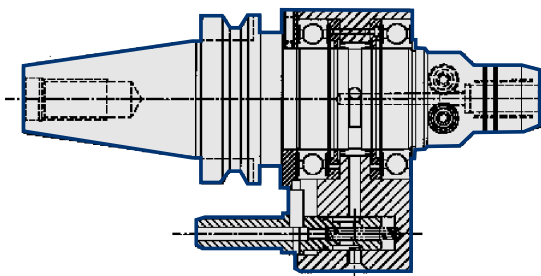

- Special applications for minimised run out and through coolant.
- Drawing depicts BT50-R-HYD20.

### ■ All Taper Types

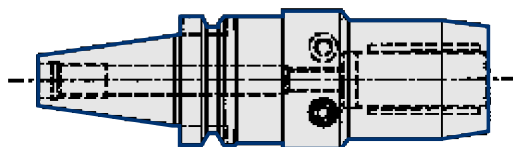

- Other Tapers to order including:
- Modular systems
- Straight Shank
- Morse Tapers
- Drawing depicts BT30 to 20mm Bore

## SuperaC: Special Hydraulic

### Workholding Applications

#### ■ Expanders For Workholding Applications

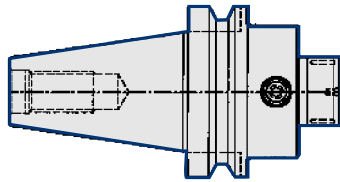
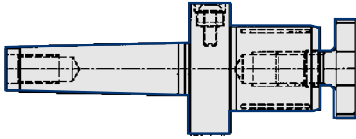

- For gripping on internal diameters
- Can be used as inspection fixture
- Accurate location - within 3 microns
- Taper/flange mounted
- Gripping diameter up to 60mm
- 3 micron run out

#### ■ Hydraulic Gripping For Workholding Applications

Manual version

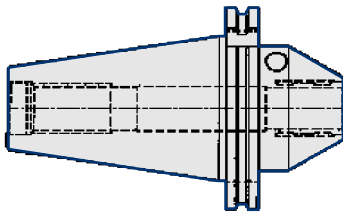

Automated version

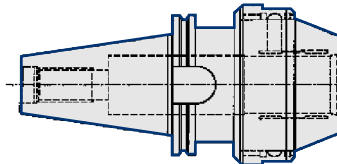

- Taper/flange mounted
- Manual screw generation
- Unique design, enables clamp/unclamp by robot in fully automated machining cycles
- Bore sizes up to 120mm

#### ■ Automated For Workholding Applications

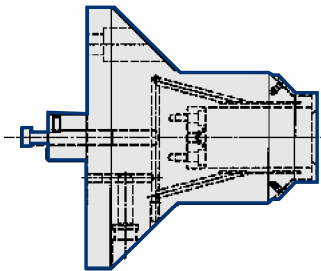
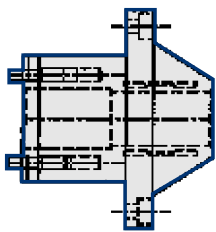

- Automatic clamping within machine cycle
- Used extensively on tool & cutter grinding machines as OEM fixture or retrofit
- High accuracy - 3 microns max run out
- Good access for grinding wheels/cutters

